

OUR SPACES

YOUR EVENT DESTINATION



AWARD-WINNING
LANDMARK VENUE
IN THE HEART OF
EASTSIDE BIRMINGHAM

MILLENNIUM POINT

WHO ARE MILLENNIUM POINT

Millennium Point is a landmark public building and multi-award-winning conference and events venue in the east side of Birmingham city centre.

We're the home to 11 flexible spaces suitable for almost any event, from purpose built meeting suites to a newly upgraded giant screen auditorium perfect for conferences right through to esports tournaments.

We're owned by the Millennium Point Charitable Trust with profits from our commercial activity being invested in projects, events and initiatives which support the growth of science, technology, engineering, and maths (STEM) in Birmingham and the wider region.

In 2021 our Charitable Trust reached a landmark £30 million in STEM support to organisations across the West Midlands over the last seven years alone.

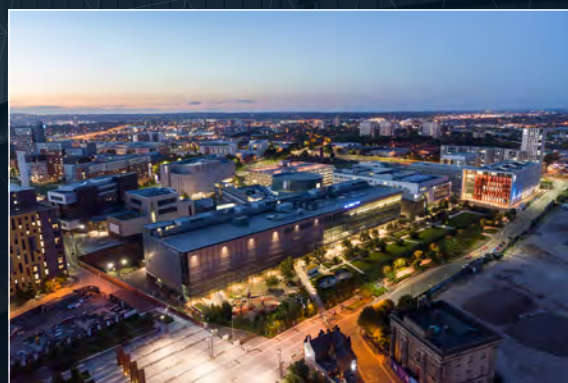



MILLENNIUM POINT

OUR EVENT SPACES

With a versatile range of both public and private spaces available for hire, Millennium Point is the ideal location for exhibitions and networking, launches and banqueting, and interviews and performances.

All of our event spaces are equipped with high speed Wi-Fi.

The five-storey central **ATRIUM** provides a modern, public setting with high footfall, whilst **CONNECT** provides a discreet setting for private meetings and events and our **AUDITORIUM** is the perfect location for film screenings, award ceremonies, conferences, lectures, product launches and AGM's.

When you book an event with us, we ensure that everything runs smoothly from start to finish. We can offer support with venue management and visitor marketing, and have a range of catering packages to choose from.



KEY FEATURES



NOT FOR PROFIT

All our profits from the events business goes back into our charitable trust, giving back STEM support for related projects, initiatives, organisations and individuals across the West Midlands.



SUSTAINABLE

We have adapted to try and become greener to protect our planet and promote the importance of sustainability, through energy management, recycling and encouraging staff to make green travel choices.

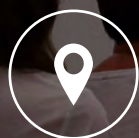

LOCATION

We are located in the heart of Birmingham city centre, an easy walk from all three mainline train stations and a short drive from the M6.



CUTTING EDGE TECHNOLOGY

Our venue is equipped with the latest cutting edge technology, from high quality video conferencing, to intelligent LED lighting and high fidelity audio.

MILLENNIUM POINT

AUDITORIUM

Accommodating up to 354 delegates, our **AUDITORIUM** is the perfect location for conferences, lectures, product launches, AGM's, award ceremonies and film screenings. Featuring a 30m² stage and a giant screen, this space is perfect for making a big impression.

Our **AUDITORIUM** space is also equipped with the latest range of hybrid and live streaming capabilities, giving you the opportunity to reach out to more delegates wherever they are.

We have upgraded AV equipment which includes a M32R digital mixing desk with 40 input channels, high fidelity audio, intelligent LED lighting system and Panasonic PTC-280 cameras controlled remotely for high quality live streaming.

Additional space for catering, registration, networking & exhibition stands is available by adding our **PLATFORM** space to your booking.

With direct access to our **AUDITORIUM** via lift or stairs the two spaces work together perfectly to make the most of your event.



KEY FEATURES



Newly refurbished 30m² stage.



Giant screen with approx 14m x 8m image size.



Hybrid event and live streaming capabilities.



Multiple branding opportunities available.

MILLENNIUM POINT

PLATFORM

PLATFORM overlooks the **ATRIUM** from Level 1 and is the ideal catering, networking and exhibition space for bookings using the **AUDITORIUM**.

The fully accessible, versatile space is perfect for receptions, launches, banquets, fund raisers and award ceremonies and has the open and spacious feel that a conventional meeting room doesn't have.

Take advantage of the presentation screen, integrated PA system and stage that will capture guests' attention.

PLATFORM can also be transformed into a dinner space with food and drink packages available, private bar and endless opportunities for theming and dressing of the space. A dance floor can also be made available for guests to enjoy throughout the event.

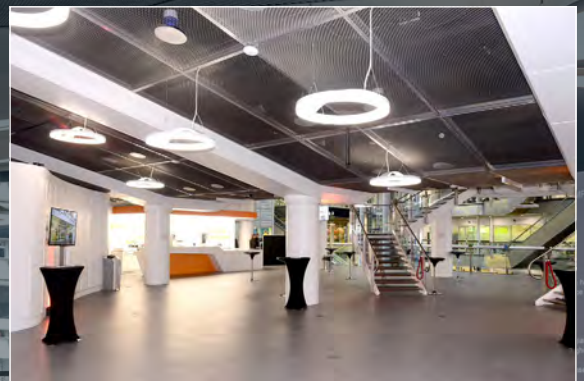

KEY FEATURES



Direct access to the auditorium



Private bar facility



Presentation stage



Natural daylight

MILLENNIUM POINT

CONNECT EVENT SPACE

A truly flexible approach to meetings & conferences **CONNECT EVENT SPACE** provides the latest in AV & presentation facilities and high speed Wi-Fi for up to 100 guests.

The retractable walls ensure you can create the ideal solution for presentations, meetings, workshops, training & away days.

The adjoining welcome area offers the perfect space to greet your guests where they can enjoy authentic Italian style beverages from our touch screen coffee machines.



KEY FEATURES



Wireless presentation facilities



Video conferencing facilities



Flexible lighting to match your brand



Touch screen coffee machines

MILLENNIUM POINT

CONNECT 1-3 MEETING ROOMS

The flexible **CONNECT 1-3** Meeting Rooms offer a high end environment for a range of events including board meetings, interviews, seminars and away days.

The three interconnected rooms offer a selection of layouts for up to 40 guests as well as benefiting from integrated screen & presentation facilities.



KEY FEATURES



Wireless presentation facilities



Video conferencing and audio playback



Flexible lighting to match your brand



Touch screen coffee machines

MILLENNIUM POINT

LEVEL 4 ENGINE

ENGINE brings a versatile approach to meetings and smaller conferences as well as being perfectly situated to act as breakout space from the nearby **AUDITORIUM**.

ENGINE is bright and airy with natural daylight and is fitted with the latest AV, presentation facilities and dedicated Level 4 high-speed Wi-Fi.

You will also have the option to add adjoining **INTER-CITY** and **JUNCTION** meeting rooms to create your own private event suite.



KEY FEATURES



Natural Daylight



Presentation Facilities



Video Conferencing



Dedicated reception area

MILLENNIUM POINT

LEVEL 4 INTER-CITY

INTER-CITY is a versatile space suitable for board meetings, training & workshops.

As part of the Level 4 events suite this bright & airy room offers all the elements needed to create a productive atmosphere for your delegates.

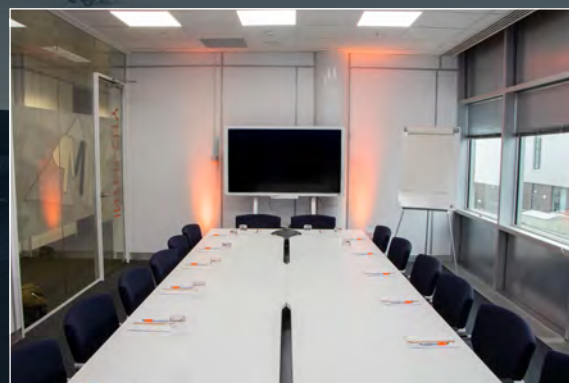

KEY FEATURES



Natural Daylight



Presentation Facilities



Dedicated reception area



Video conferencing

MILLENNIUM POINT

LEVEL 4 JUNCTION

JUNCTION is a work space perfect for an events office, green room or interviews.

The room has access to integrated projection & playback as well as having the option to add video conferencing facilities onto your booking.

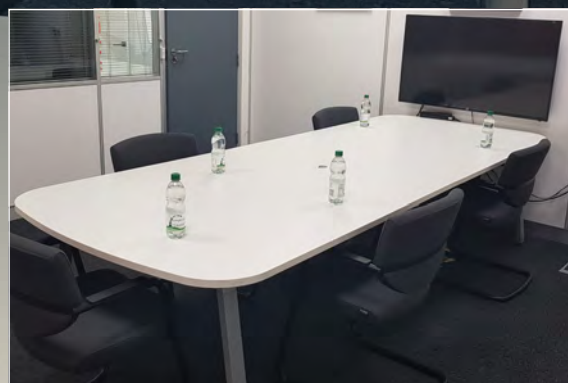

KEY FEATURES



Integrated projection



Dedicated reception area



Video conferencing



Fixed boardroom

MILLENNIUM POINT

ATRIUM

Located on Level 0, **ATRIUM** is a visually impressive, open-plan public space, ideally suited to dinners, exhibitions, brand activations, visual arts, open days and pop up-performances.

Offering over 400m² of space, 3-phase power ground floor load-in in this unique area gives endless creative possibilities for your event.

The space has even been used as a film set for major TV programmes.



KEY FEATURES



Vehicle access



High footfall



Natural daylight



Direct access to Concourse

MILLENNIUM POINT

CONCOURSE

Located on Level 2, in a high footfall area between BCU's entrance and Thinktank, **CONCOURSE** is perfect for a gallery or exhibition space and has views of Eastside Park.

Whether displaying products, advertising services or exhibiting artwork, **CONCOURSE** offers a perfect opportunity to access the range of audiences native to Millennium Point.

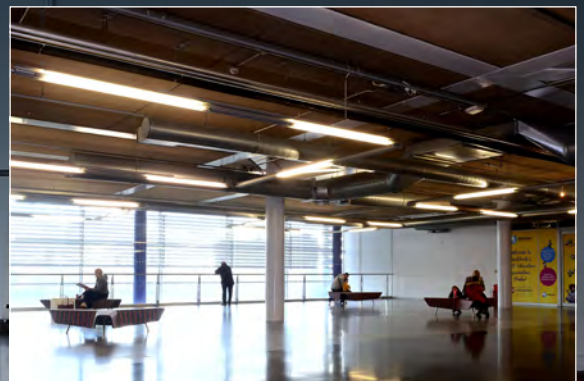

KEY FEATURES



Natural daylight



High footfall



Overlooks Atrium



250m² gallery space

MILLENNIUM POINT

INGRESS

Adjacent to **PLATFORM** on Level 1, **INGRESS** is a small, outdoor space – the ideal location for street food stalls, vehicle displays and outdoor exhibits.



KEY FEATURES



Close to parking facilities



Vehicle accessible



External power supply



Outdoor furniture

MILLENNIUM POINT

PROMENADE

Millennium Point's bustling, south-facing pathway is the perfect location for outdoor food fairs, craft exhibitions and intimate outdoor events.

With links to Eastside Park, **PROMENADE** also provides an excellent showcase area for vehicles and displays.

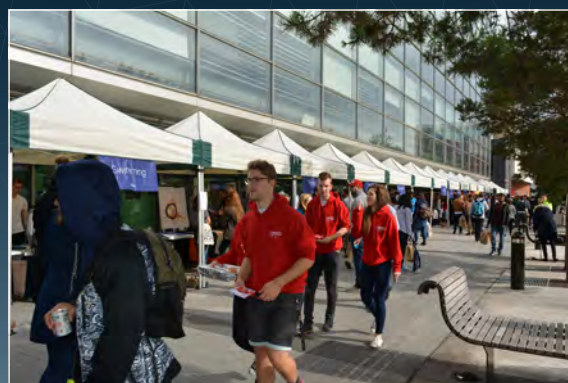

KEY FEATURES



External power supply



Vehicle accessible



High footfall



Short walk to Eastside park



MILLENNIUM POINT

HOW TO FIND US



BY FOOT

Millennium Point is a 10 minute walk from the city centre.



BY TRAIN

Less than 1 mile from Moor Street, New Street and Snow Hill Stations.



BY CAR

Easily accessible from the M6, M5 and M42. Located opposite a multi-storey car park.



MILLENNIUM POINT

VENUE CAPACITIES

ATRIUM

An impressive, open-plan public space, ideally suited to exhibitions, vehicle and product displays and pop-up performances.

ROOM	THEATRE	CABARET	BOARDROOM	U-SHAPE	CLASSROOM	BANQUETING	STANDING RECEPTION	EXHIBITION STANDS
Atrium	-	-	-	-	-	350	500	50

PLATFORM & AUDITORIUM

Hire together or individually, our PLATFORM and AUDITORIUM event spaces are the ideal location for networking, dinners, drinks receptions and exhibitions that make a big impression.

ROOM	THEATRE	CABARET	BOARDROOM	U-SHAPE	CLASSROOM	BANQUETING	STANDING RECEPTION	EXHIBITION STANDS
Platform	150	152	30	28	36	250	350	20
Auditorium	354	-	-	-	-	-	-	-

CONNECT

A purpose-built event suite with four inter-connecting rooms with space for up to 120 people. Ideal for small meetings, conferences and training.

ROOM	THEATRE	CABARET	BOARDROOM	U-SHAPE	CLASSROOM	BANQUETING	STANDING RECEPTION	EXHIBITION STANDS
CONNECT Event Space (Partition Open)	110	56	30	28	30	64	120	10
CONNECT Event Space (Partition Closed)	80	42	24	20	24	48	100	8
CONNECT Meeting Room 1	10	-	8	6	-	-	-	-
CONNECT Meeting Room 2	14	-	10	8	-	-	-	-
CONNECT Meeting Room 3	20	12	12	10	6	-	25	-
CONNECT Meeting Room 1 and 2	24	12	12	10	12	-	30	-
CONNECT Meeting Room 2 and 3	30	18	16	14	14	-	40	-
CONNECT Meeting Room 1, 2 and 3	40	18	24	22	16	-	60	6

CONCOURSE

This high footfall public space between the entrances for BCU and ThinkTank means that you'll get the benefit of mix Millennium Point's audience, plus your own!

ROOM	THEATRE	CABARET	BOARDROOM	U-SHAPE	CLASSROOM	BANQUETING	STANDING RECEPTION	EXHIBITION STANDS
Concourse	-	-	-	-	-	-	200	12

LEVEL 4

Private, furnished meeting spaces ideal for those looking for something sweet and simple at excellent value for money.

ROOM	THEATRE	CABARET	BOARDROOM	U-SHAPE	CLASSROOM	BANQUETING	STANDING RECEPTION	EXHIBITION STANDS
Junction	-	-	9	-	-	-	-	-
Intercity	40	12	18	-	16	-	-	-
Engine	60	49	28	24	32	64	80	12





Millennium Point
Curzon Street
Birmingham B4 7XG

t 0121 202 2200

e events@millenniumpoint.org.uk

w millenniumpoint.org.uk/venuehire